

5. OVERVIEW OF FUNCTIONS OF COMPRESSORS

5.1 Compressor with Dry-air System

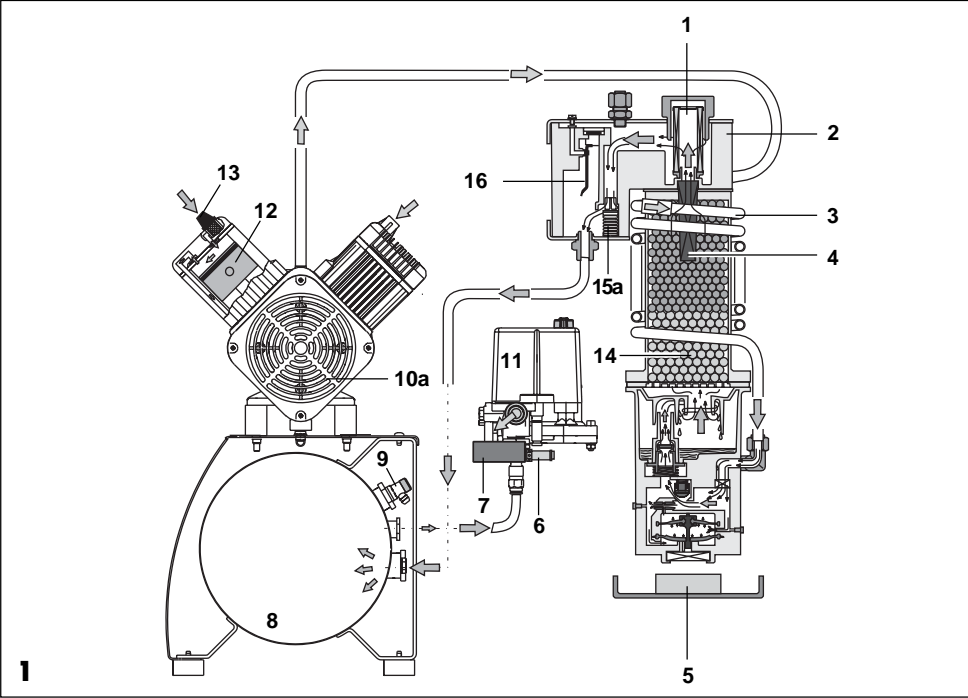

5.2 Compressor without Dry-air System

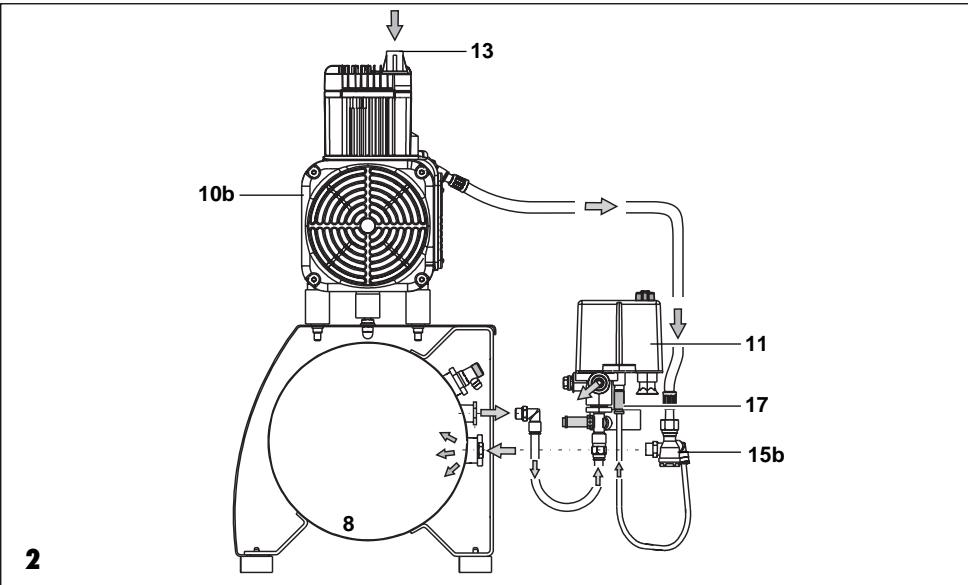

4. TECHNICAL DATA

Model		Primo			Duo		Trio	Quattro
		5150-01a 5151-01b	5250-01a 5251-01b	5250-51a 5251-51b	5351-01b	5450-51a 5451-51b		
Voltage	V	230	230	400	230	400		
Frequency	Hz	50 – 60	50 – 60	50 – 60	50	50 – 60		
Current Consumption at 8 bar	A	4,3 ^c – 4,4 ^c	6,3 ^c – 7,0 ^c	3,1 ^c – 2,5 ^c	8,6	4,4 ^c – 4,8 ^c		
Motor Protection Switch max. permissible setting	A	6,3	8,5	3,5	10,0	6,3		
recommended setting		5,6 ^c – 4,4 ^c	6,5 ^c – 7,6 ^c	3,2 ^c – 2,5 ^c	8,6	4,4 ^c – 5,0 ^c		
Rated Output	kW	0,80 ^c – 0,98 ^c	1,30 ^c – 1,60 ^c	1,40	1,90	2,20 ^c – 2,95 ^c		
Speed	min ⁻¹	1440 ^c – 1710 ^c	1360 ^c – 1600 ^c	1410 ^c – 1690 ^c	1350	1440 ^c – 1700 ^c		
Mains Fuse		LS-10A ^d	LS-10A ^d	LS-10A ^d	LS-10A ^d	LS-10A ^d		
Protection System		IP54	IP54	IP54	IP54	IP54		
Noise Level	dB(A)	67 ^c – 72 ^c	71 ^c – 75 ^c	72 ^c – 76 ^c	77	75 ^c – 77 ^c		
Number of Cylinders	Zyl.	1	2	2	3	4		
Delivery at 5 bar	l/min							
w. DAS ^b		60 ^c – 70 ^c	110 ^c – 120 ^c	110 ^c – 120 ^c	165	230 – 260		
w/o. DAS ^a		60 ^c – 70 ^c	115 ^c – 130 ^c	115 ^c – 130 ^c	–	235 – 270		
Switch-on/off Pressure	bar	5,5 / 7,5	5,5 / 7,5	5,5 / 7,5	5,5 / 7,5	5,5 / 7,5		
Safety Valve - Admissible								
Operating Pressure	bar	10	10	10	10	10		
Volume of Pressure Tank	l	20	20	20	50	50		
Duty cycle	%							
w. DAS ^b		50	50	50	50	50		
w/o. DAS ^a		100	100	100	–	–		
Grade of Filtration, Cartridge for compressor	µm	10	10	10	10	10		
Grade of Filtr., Fine-mesh Filter for DAS	µm	1	1	1	1	1		
Grade of Filtr., Sterilised Filter for DAS	µm	0,01	0,01	0,01	0,01	0,01		
Weight w. DAS ^b	kg	56	57	57		90		
w/o. DAS ^a		47	49	49	87	–		
Dimensions (H x W x D)	cm							
w. DAS ^b		64 x 49 x 46	64 x 49 x 47	64 x 49 x 47	86 x 74 x 51	86 x 74 x 51		
w/o. DAS ^a		64 x 49 x 44	64 x 49 x 45	64 x 49 x 45	–	70 x 74 x 50		
Charging Time 0 – 7.5 bar	s							
w. DAS ^b		135 ^c – 120 ^c	75 ^c – 65 ^c	75 ^c – 65 ^c	130	95 ^c – 80 ^c		
w/o. DAS ^a		125 ^c – 105 ^c	65 ^c – 55 ^c	65 ^c – 55 ^c	–	–		

^a w/o. DAS (without dry-air system)

^b w. DAS (with dry-air system)

^c depending on mains frequency

^d mains fuse: 10 A LS-switch, characteristics B, C, and D according to DIN EN 60898

Duo Tandem		Quattro Tandem		Tornado 70	Tornado 130	
4251-01b / 4151-51b	4251-51b	4641-51b	4680-51a 4681-51b	5170-01a 5171-01b	5270-01a 5271-01b	5270-02a 5271-02b
2 Aggregate 1 Aggregate	2 Aggregates	1 Aggregate	2 Aggregates			
230/400	400	400	400	230	230	220
50–60	50–60	50–60	50–60	50–60	50	60
12,2 ^c –14,3 ^c 3,1 ^c –2,5 ^c	6,2 ^c –5,0 ^c	4,4 ^c –4,8 ^c	8,8 ^c –9,6 ^c	4,9 ^c –4,3 ^c	6,7	7,9
- / 3,5 6,5 ^c –7,6 ^c /3,2 ^c –2,5 ^c	3,5 3,2 ^c –2,5 ^c	6,3 4,4 ^c –5,0 ^c	6,3 4,4 ^c –5,0 ^c	6,3 5,1 ^c –4,3 ^c	8,5 7	10,0 8,0
2,7 ^c –3,3 ^c / 1,40	2,80 ^c –2,84 ^c	2,2 ^c –2,95 ^c	4,4 ^c –5,9 ^c	0,92 ^c –0,97 ^c	1,42	1,70
1410 ^c –1690 ^c	1410 ^c –1690 ^c	1440 ^c –1700 ^c	1440 ^c –1700 ^c	1420 ^c –1700 ^c	1380	1710
LS-10A ^d	LS-10A ^d	LS-10A ^d	LS-10A ^d	LS-10A ^d	LS-10A ^d	LS-10A ^d
IP 54	IP 54	IP 54	IP 54	IP 54	IP 54	IP 54
72 ^c –76 ^c	75 ^c –77 ^c	74 ^c –76 ^c	76 ^c –79 ^c	67 ^c –70 ^c	70 ^b –72 ^a	72 ^b –75 ^a
2 x 2 / 2	2 x 2	4	2 x 4	1	2	2
215 ^c –240 ^c / 110 ^c –120 ^c	220 ^c –240 ^c –	230 ^c –260 ^c –	460 ^c –520 ^c 470 ^c –540 ^c	67 ^c –69 ^c 70 ^c –80 ^c	115 130	125 150
5,5/7,5	5,5/7,5	6,5/8,5	6,5/8,5	5,5/7,5	5,5/7,5	5,5/7,5
10	10	10	10	10	10	10
50	50	90	90	20	20	20
50 –	50 –	50 –	50 –	50 100	50 100	50 100
10	10	10	10	10	10	10
1 0,01	1 0,01	1 0,01	1 0,01	1 0,01	1 0,01	1 0,01
87 71	97 –	114 –	175 –	52 44	67 59	67 59
86 x 76 x 51 –	86 x 76 x 51 –	86 x 103 x 63 –	86 x 103 x 63 75 x 103 x 63	64 x 49 x 46 64 x 49 x 44	64 x 49 x 46 64 x 49 x 44	64 x 49 x 46 64 x 49 x 44
171 ^c –147 ^c –	86 ^c –76 ^c –	165 ^c –135 ^c –	76 ^c –66 ^c –	130 ^c –115 ^c 100 ^c –85 ^c	65 45	55 40

Climatic Conditions for Storage and Transport

Temperature –25 °C to +55 °C, 24h to +70 °C

Relative Atmospheric Humidity 10 % to 90 % (without condensation)

Climatic Conditions for Operation

Temperature +10 °C to 40 °C

Relative Atmospheric Humidity up to +70 %